

**CSU Maritime Academy  
Rizza Auditorium  
Hazard Material Survey**



Sampled for **asbestos** and **detected**  
Sampled for **lead** and **detected**

This is a quick reference summary of a survey completed by Vista Environmental in October 2024. The complete report is available by contacting EH&S at [safety@sum.edu](mailto:safety@sum.edu). If unsure about ANY information contact EH&S prior to impacting suspect material.

***Positive Asbestos Locations***

<b>MATERIAL</b>	<b>DESCRIPTION</b>	<b>LOCATION</b>	<b>ESTIMATED QUANTITY</b>
Vinyl Floor Tile/Mastic	12" Tan/Black Streaks/Black	Hallways to 114 & 115	105 SF
Basecove/Mastic	4" Black/Brown	Rooms 101, 102, 103, 104, 106, 107, 112, 117, 204, and Hallways to 114 & 115	30 SF (900 LF)
Panel/Mastic	White, Textured/Black	Rooms 104, 106, 107, 201 and Mechanical Room above 106	4,000 SF
Vinyl Floor Tile/Mastic	12" Beige, Beige Streaks	Room 204	300 SF
Sealant	White/Gray, Louver	Exterior - NW & NE Louvers	4 SF (48 LF)

***Positive Asbestos Locations***

<b>HOMO ID</b>	<b>MATERIAL</b>	<b>DESCRIPTION</b>	<b>LOCATION</b>	<b>CAL/OSHA CLASS</b>	<b>BAAQMD CATEGORY</b>
B	Vinyl Floor Tile/Mastic	12" Tan/Black Streaks/Black	Hallways to 114 & 115	Class II	Category I - Non-Friable
C	Basecove/Mastic	4" Black/Brown	Rooms 101, 102, 103, 104, 106, 107, 112, 117, 204, and Hallways to 114 & 115	Class II	Category I - Non-Friable
K	Panel/Mastic	White, Textured/Black	Rooms 104, 106, 107, 201 and Mechanical Room above 106	Class II	Category I - Non-Friable
Q	Vinyl Floor Tile/Mastic	12" Beige, Beige Streaks	Room 204	Class II	Category I - Non-Friable
T	Sealant	White/Gray, Louver	Exterior - NW & NE Louvers	Class II	Category I - Non-Friable

The results of the bulk samples collected for asbestos, and analyzed by PLM, indicate that detectable concentrations of asbestos ***are not present*** in the following materials:

HOMOGENEOUS ID	MATERIAL	DESCRIPTION	# OF SAMPLES
A	Wallboard/Joint Compound	White/White	3
D	Mastic	Yellow, Carpet Square	2
E	Acoustical Ceiling Tile/Mastic	12" White, Fissured	2
F	Mortar/Grout	White/White, Ceramic Wall & Base	1
G	Mortar/Grout	White/White, Ceramic Floor	1
H	Brick/Mortar	Red/Gray	2
I	Coating	Gray, Floor	2
J	Tape	White, Duct	2
L	Concrete	Gray, Foundation	2
M	Jacketing	White, Fiberglass Pipe	2
N	Flex Connector	Black, HVAC	1
O	Firestop	Red	2
P	Basecove/Mastic	4" Gray/Beige	2
R	Sealant	Gray, Storefront	2
S	Paint/Stucco	White/Gray, Eaves & Walls	3
U	Sealant	Gray, Exterior Pipe Chase	1
V	Roofing	White & Black, Built-Up	2
W	Parapet	White & Black, Built-Up	2
X	Mastic	Gray & Black	2
Y	Coating	White & Yellow, Duct	2
Z	Sealant	Gray, Flashing Seam	2
AA	Shingle/Underlayment	Brown/Black, 3 Tab	2

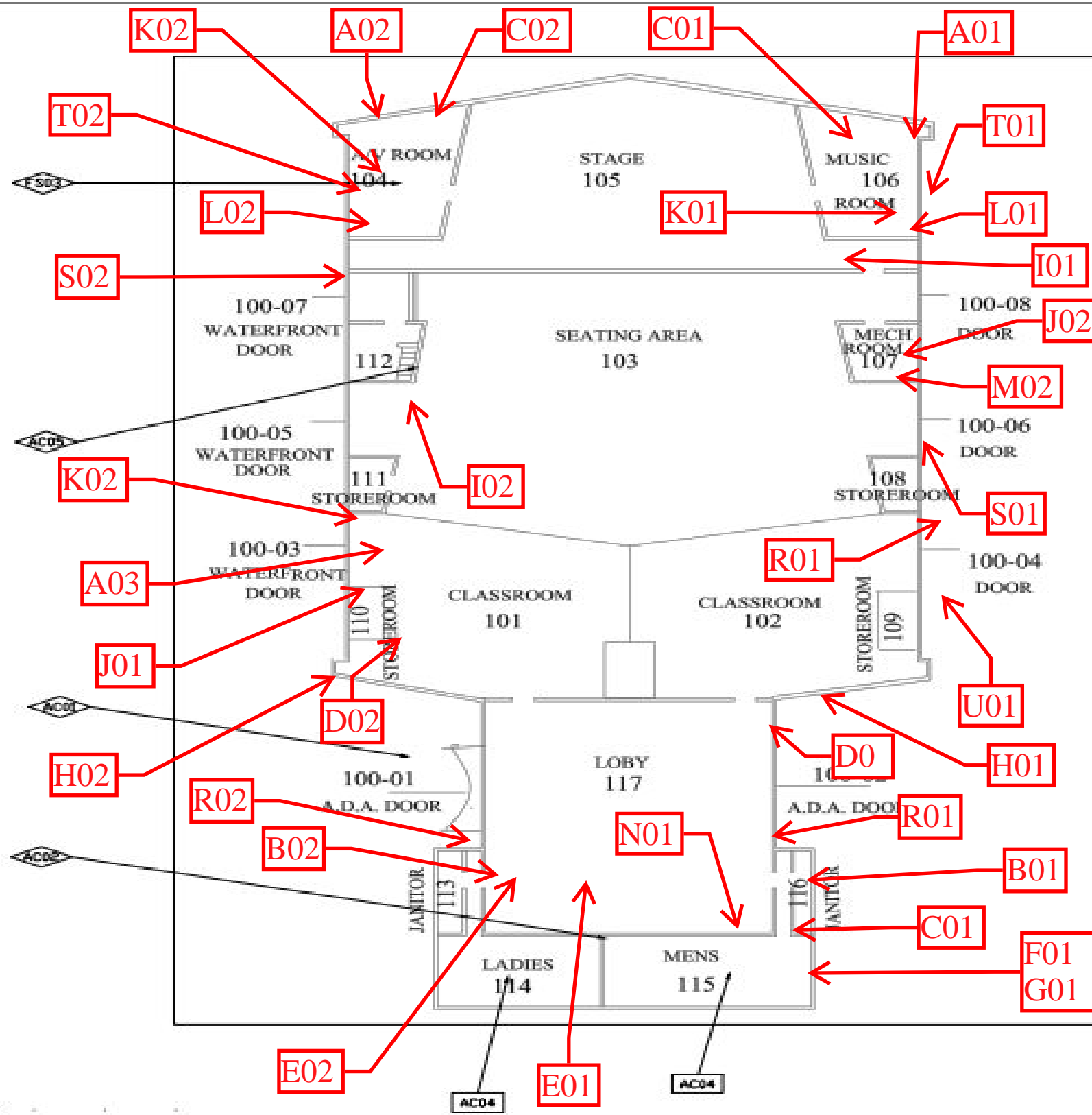

***Positive Lead Locations***

ROOM	COMPONENT	SUBSTRATE	COLOR	CONDITION	Pb	UNITS
Inside	Lower Wall	Drywall	Off White	Intact	0.2	mg/cm <sup>2</sup>
Inside	Lower Wall	Drywall	Off White	Intact	0.1	mg/cm <sup>2</sup>
Inside	Lower Wall	Drywall	Light Gray	Intact	0.1	mg/cm <sup>2</sup>
Inside	Lower Wall	Drywall	Light Gray	Intact	0.1	mg/cm <sup>2</sup>
Inside	Lower Wall	Drywall	Black	Intact	0.1	mg/cm <sup>2</sup>
Inside	Stairs	Concrete	Gray	Intact	0.4	mg/cm <sup>2</sup>
Inside	Stairs	Concrete	Gray	Intact	0.2	mg/cm <sup>2</sup>
Inside	Stringer	Vinyl	Black	Intact	0.4	mg/cm <sup>2</sup>
Inside	Stringer	Vinyl	Black	Intact	0.2	mg/cm <sup>2</sup>
Inside	Baseboard	Vinyl	Black	Intact	0.1	mg/cm <sup>2</sup>
Inside	Baseboard	Vinyl	Black	Intact	0.2	mg/cm <sup>2</sup>
Inside	Stringer	Wood	Gray	Intact	0.1	mg/cm <sup>2</sup>
Inside	Baseboard	Vinyl	Gray	Intact	0.1	mg/cm <sup>2</sup>
Inside	Baseboard	Vinyl	Gray	Intact	0.1	mg/cm <sup>2</sup>
Inside	Door Frame	Wood	Off White	Intact	0.1	mg/cm <sup>2</sup>
Inside	Door Frame	Wood	Off White	Intact	0.1	mg/cm <sup>2</sup>
<b>Inside</b>	<b>Railing</b>	<b>Metal</b>	<b>Light Blue</b>	<b>Intact</b>	<b>14.6</b>	<b>mg/cm<sup>2</sup></b>
Inside	Lower Wall	Drywall	Beige	Intact	0.1	mg/cm <sup>2</sup>
Inside	Lower Wall	Drywall	Beige	Intact	0.1	mg/cm <sup>2</sup>
Inside	Lower Wall	Other	White	Intact	0.2	mg/cm <sup>2</sup>
Inside	Lower Wall	Other	White	Intact	0.2	mg/cm <sup>2</sup>
Inside	Door Frame	Metal	Beige	Intact	0.1	mg/cm <sup>2</sup>
Inside	Floor	Concrete	Gray	Intact	0.2	mg/cm <sup>2</sup>
Inside	Floor	Concrete	Gray	Intact	0.1	mg/cm <sup>2</sup>
<b>Inside</b>	<b>Railing</b>	<b>Metal</b>	<b>Black</b>	<b>Intact</b>	<b>15</b>	<b>mg/cm<sup>2</sup></b>
Inside	Door	Wood	Varnish	Intact	0.1	mg/cm <sup>2</sup>
Inside	Door Frame	Wood	Black	Intact	0.1	mg/cm <sup>2</sup>
Inside	Lower Wall	Wood	Gray	Intact	0.1	mg/cm <sup>2</sup>
Inside	Lower Wall	Wood	Gray	Intact	0.1	mg/cm <sup>2</sup>
Inside	Door	Wood	Gray	Intact	0.1	mg/cm <sup>2</sup>

ROOM	COMPONENT	SUBSTRATE	COLOR	CONDITION	Pb	UNITS
<b>Inside</b>	<b>Beam</b>	<b>Metal</b>	<b>Orange</b>	<b>Intact</b>	<b>16.5</b>	<b>mg/cm<sup>2</sup></b>
<b>Inside</b>	<b>Railing</b>	<b>Metal</b>	<b>Black</b>	<b>Intact</b>	<b>16.6</b>	<b>mg/cm<sup>2</sup></b>
Inside	Railing	Wood	Varnish	Intact	0.1	mg/cm <sup>2</sup>
Inside	Railing	Wood	Varnish	Intact	0.2	mg/cm <sup>2</sup>
Outside	Lower Wall	Stucco	White	Intact	0.1	mg/cm <sup>2</sup>
Outside	Railing	Metal	Yellow	Intact	0.1	mg/cm <sup>2</sup>
Outside	Lower Wall	Other	Off White	Intact	0.3	mg/cm <sup>2</sup>
Outside	Lower Wall	Other	Off White	Intact	0.1	mg/cm <sup>2</sup>
Outside	Lower Wall	Metal	Off White	Intact	0.1	mg/cm <sup>2</sup>
Outside	Flashing	Metal	Dark Brown	Intact	0.1	mg/cm <sup>2</sup>
Outside	Flashing	Metal	Dark Brown	Intact	0.2	mg/cm <sup>2</sup>
<b>Inside</b>	<b>Ladder</b>	<b>Metal</b>	<b>Beige</b>	<b>Intact</b>	<b>6.7</b>	<b>mg/cm<sup>2</sup></b>
Outside	Flashing	Metal	Dark Brown	Intact	0.3	mg/cm <sup>2</sup>
<b>Outside</b>	<b>Pipe</b>	<b>Metal</b>	<b>White</b>	<b>Intact</b>	<b>71</b>	<b>mg/cm<sup>2</sup></b>

*Bold = Lead Based*

### *XFR Lead Sample Locations*

READING NO.	ROOM	COMPONENT	SUBSTRATE	COLOR	CONDITION	RESULTS	PbC	UNITS
96		Calibrate				Negative	0.8	mg/cm2
97		Calibrate				Negative	0.8	mg/cm2
98		Calibrate				Negative	0.8	mg/cm2
227	Inside	Lower Wall	Drywall	Off White	Intact	Negative	0.2	mg/cm2
228	Inside	Lower Wall	Drywall	Off White	Intact	Negative	0.1	mg/cm2
229	Inside	Lower Wall	Brick	Off White	Intact	Negative	0	mg/cm2
230	Inside	Lower Wall	Brick	Off White	Intact	Negative	0	mg/cm2
231	Inside	Lower Wall	Brick	Off White	Intact	Negative	0	mg/cm2
232	Inside	Lower Wall	Drywall	Lt-Gray	Intact	Negative	0.1	mg/cm2
233	Inside	Lower Wall	Drywall	Lt-Gray	Intact	Negative	0.1	mg/cm2
234	Inside	Lower Wall	Drywall	Black	Intact	Negative	0	mg/cm2
235	Inside	Lower Wall	Drywall	Black	Intact	Negative	0.1	mg/cm2
236	Inside	Stairs	Concrete	Gray	Intact	Negative	0.4	mg/cm2
237	Inside	Stairs	Concrete	Gray	Intact	Negative	0.2	mg/cm2
238	Inside	Stringer	Vinyl	Black	Intact	Negative	0.4	mg/cm2
239	Inside	Stringer	Vinyl	Black	Intact	Negative	0.2	mg/cm2
240	Inside	Baseboard	Vinyl	Black	Intact	Negative	0.1	mg/cm2
241	Inside	Baseboard	Vinyl	Black	Intact	Negative	0.2	mg/cm2
242	Inside	Stringer	Wood	Gray	Intact	Negative	0.1	mg/cm2
243	Inside	Stringer	Wood	Gray	Intact	Negative	0	mg/cm2
244	Inside	Baseboard	Wood	Gray	Intact	Negative	0	mg/cm2
245	Inside	Baseboard	Wood	Gray	Intact	Negative	0	mg/cm2
246	Inside	Baseboard	Vinyl	Gray	Intact	Negative	0.1	mg/cm2
247	Inside	Baseboard	Vinyl	Gray	Intact	Negative	0.1	mg/cm2
248	Inside	Door	Wood	Varnish	Intact	Negative	0	mg/cm2
249	Inside	Door	Wood	Varnish	Intact	Negative	0	mg/cm2
250	Inside	Door Frame	Wood	Off White	Intact	Negative	0.1	mg/cm2
251	Inside	Door Frame	Wood	Off White	Intact	Negative	0.1	mg/cm2

This data is a screening of lead levels and provides results that are generally representative of typical conditions, but are not inclusive of all painted/coated surfaces at the Project Site.

### *XFR Lead Sample Locations*

READING NO.	ROOM	COMPONENT	SUBSTRATE	COLOR	CONDITION	RESULTS	PbC	UNITS
252	Inside	Railing	Metal	Lt-Blue	Intact	Positive	14.6	mg/cm <sup>2</sup>
253	Inside	Door	Metal	Black	Intact	Negative	0	mg/cm <sup>2</sup>
254	Inside	Door	Metal	Black	Intact	Negative	0	mg/cm <sup>2</sup>
255	Inside	Lower Wall	Drywall	Beige	Intact	Negative	0.1	mg/cm <sup>2</sup>
256	Inside	Lower Wall	Drywall	Beige	Intact	Negative	0.1	mg/cm <sup>2</sup>
257	Inside	Lower Wall	Other	White	Intact	Negative	0.2	mg/cm <sup>2</sup>
258	Inside	Lower Wall	Other	White	Intact	Negative	0.2	mg/cm <sup>2</sup>
259	Inside	Door Frame	Metal	Beige	Intact	Negative	0.1	mg/cm <sup>2</sup>
260	Inside	Door Frame	Metal	Beige	Intact	Negative	0	mg/cm <sup>2</sup>
261	Inside	Floor	Wood	Black	Intact	Negative	0	mg/cm <sup>2</sup>
262	Inside	Floor	Wood	Black	Intact	Negative	0	mg/cm <sup>2</sup>
263	Inside	Floor	Concrete	Gray	Intact	Negative	0.2	mg/cm <sup>2</sup>
264	Inside	Floor	Concrete	Gray	Intact	Negative	0.1	mg/cm <sup>2</sup>
265	Inside	Railing	Metal	Black	Intact	Positive	15	mg/cm <sup>2</sup>
266	Inside	Door	Wood	Varnish	Intact	Negative	0.1	mg/cm <sup>2</sup>
267	Inside	Door	Wood	Varnish	Intact	Negative	0	mg/cm <sup>2</sup>
268	Inside	Door Frame	Wood	Black	Intact	Negative	0.1	mg/cm <sup>2</sup>
269	Inside	Door Frame	Wood	Black	Intact	Negative	0	mg/cm <sup>2</sup>
270	Inside	Lower Wall	Wood	Gray	Intact	Negative	0.1	mg/cm <sup>2</sup>
271	Inside	Lower Wall	Wood	Gray	Intact	Negative	0.1	mg/cm <sup>2</sup>
272	Inside	Door	Wood	Gray	Intact	Negative	0.1	mg/cm <sup>2</sup>
273	Inside	Door	Wood	Gray	Intact	Negative	0	mg/cm <sup>2</sup>
274	Inside	Lower Wall	Drywall	Orange	Intact	Negative	0	mg/cm <sup>2</sup>
275	Inside	Lower Wall	Drywall	Orange	Intact	Negative	0	mg/cm <sup>2</sup>
276	Inside	Beam	Metal	Orange	Intact	Positive	16.5	mg/cm <sup>2</sup>
277	Inside	Railing	Metal	Black	Intact	Positive	16.6	mg/cm <sup>2</sup>
278	Inside	Railing	Wood	Varnish	Intact	Negative	0.1	mg/cm <sup>2</sup>
279	Inside	Railing	Wood	Varnish	Intact	Negative	0.2	mg/cm <sup>2</sup>

This data is a screening of lead levels and provides results that are generally representative of typical conditions, but are not inclusive of all painted/coated surfaces at the Project Site.



### *XFR Lead Sample Locations*

READING NO.	ROOM	COMPONENT	SUBSTRATE	COLOR	CONDITION	RESULTS	PbC	UNITS
280	Outside	Lower Wall	Stucco	White	Intact	Negative	0.1	mg/cm <sup>2</sup>
281	Outside	Lower Wall	Stucco	White	Intact	Negative	0	mg/cm <sup>2</sup>
282	Outside	Door	Metal	Gray	Intact	Negative	0	mg/cm <sup>2</sup>
283	Outside	Door	Metal	Gray	Intact	Negative	0	mg/cm <sup>2</sup>
284	Outside	Railing	Metal	Yellow	Intact	Negative	0.1	mg/cm <sup>2</sup>
285	Outside	Railing	Metal	Yellow	Intact	Negative	0	mg/cm <sup>2</sup>
286	Outside	Lower Wall	Other	Off White	Intact	Negative	0.3	mg/cm <sup>2</sup>
287	Outside	Lower Wall	Other	Off White	Intact	Negative	0.1	mg/cm <sup>2</sup>
288	Outside	Lower Wall	Metal	Off White	Intact	Negative	0	mg/cm <sup>2</sup>
289	Outside	Lower Wall	Metal	Off White	Intact	Negative	0.1	mg/cm <sup>2</sup>
290	Outside	Upper Wall	Stucco	Dk-Brown	Intact	Negative	0	mg/cm <sup>2</sup>
291	Outside	Upper Wall	Stucco	Dk-Brown	Intact	Negative	0	mg/cm <sup>2</sup>
292	Outside	Soffit	Stucco	Dk-Brown	Intact	Negative	0	mg/cm <sup>2</sup>
293	Outside	Soffit	Stucco	Dk-Brown	Intact	Negative	0	mg/cm <sup>2</sup>
294	Outside	Flashing	Metal	Dk-Brown	Intact	Negative	0.1	mg/cm <sup>2</sup>
295	Outside	Flashing	Metal	Dk-Brown	Intact	Negative	0.2	mg/cm <sup>2</sup>
296	Inside	Ladder	Metal	Beige	Intact	Positive	6.7	mg/cm <sup>2</sup>
297	Outside	Flashing	Metal	Dk-Brown	Intact	Negative	0.3	mg/cm <sup>2</sup>
298	Outside	Pipe	Metal	White	Intact	Positive	71	mg/cm <sup>2</sup>
328		Calibrate				Negative	0.9	mg/cm <sup>2</sup>
329		Calibrate				Negative	0.9	mg/cm <sup>2</sup>
330		Calibrate				Positive	1	mg/cm <sup>2</sup>

***The above list are ALL the materials sampled and tested by XRF for lead. The positive materials are in red. The non-detect samples for lead materials are in black. If you cannot positively identify the material you need to impact through the above inventory, do not disturb and contact EH&S for further sampling or guidance. The materials not listed were not sampled and must be assumed lead containing until proven not by testing***