

CALIFORNIA STATE UNIVERSITY MARITIME ACADEMY
STUDENT SERVICES BUILDING
HAZARDOUS MATERIALS SURVEY

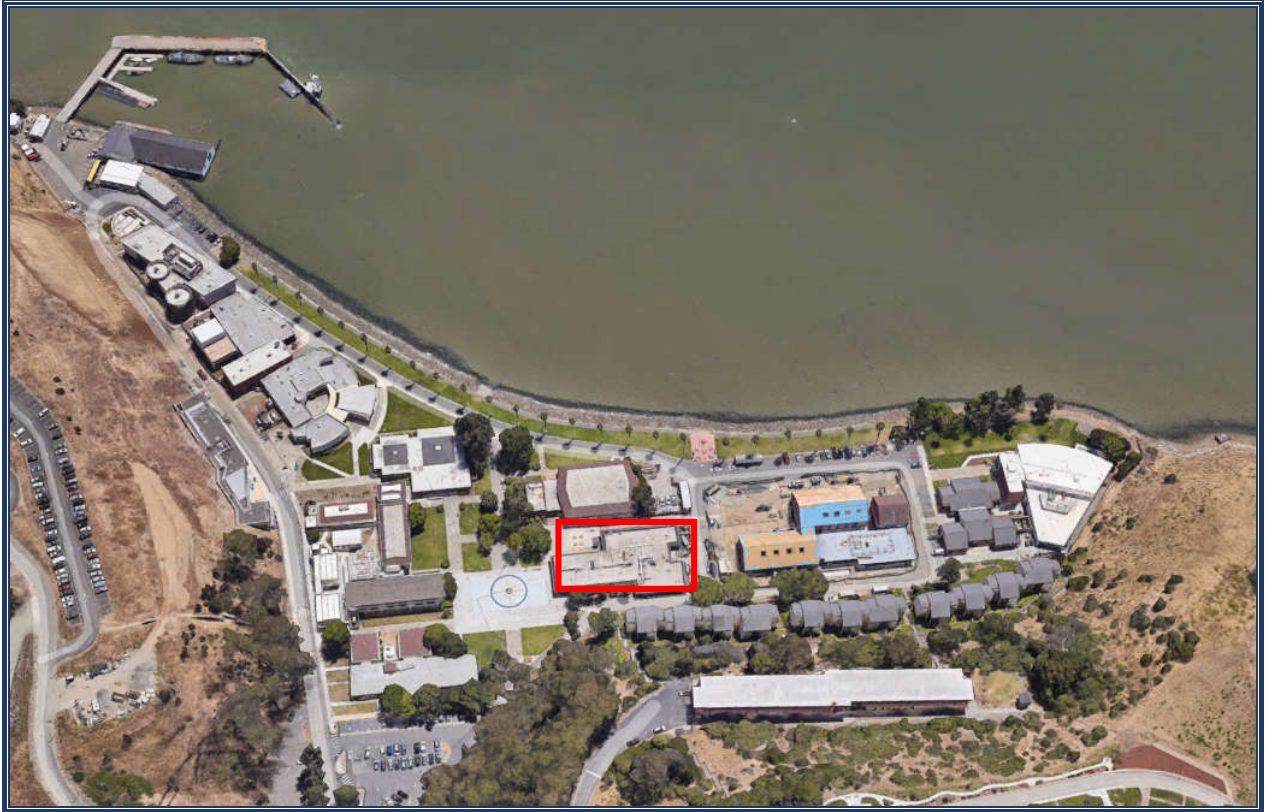

Sampled for **asbestos** and **detected**
Sampled for **lead** and **detected**

This is a quick reference summary of a survey completed by Vista Environmental in June 2023. The complete report is available by contacting EH&S at safety@csu.edu. If unsure about ANY information contact EH&S prior to impacting suspect material.

CALIFORNIA STATE UNIVERSITY MARITIME ACADEMY
STUDENT SERVICES BUILDING
HAZARDOUS MATERIALS SUMMARY

Positive Asbestos Locations

HOMO. ID	MATERIAL	DESCRIPTION	LOCATION	CAL/OSHA CLASS	BAAQMD CATEGORY	ESTIMATED QUANTITY
HH	Sealant	Black, Aluminum Window Frame	Exterior Aluminum Windows	Class II	Category I-Non-Friable	36 SF (432 LF)

**CALIFORNIA STATE UNIVERSITY MARITIME ACADEMY
STUDENT SERVICES BUILDING
ASBESTOS SAMPLING INVENTORY**

HOMOGENEOUS ID	MATERIAL	DESCRIPTION	# OF SAMPLES
A	Wallboard/Joint Compound	White/White, Texture Coat	2
B	Texture Coat	White, Small	7
C	Jacketing	White, Pipe	2
D	Tape	White. Duct	1
E	Paint/Skim Coat	White/White, Concrete	3
F	Tar	Black, Concrete	2
G	Panel	Beige, Ceiling	2
H	Wallboard	White, Unfinished	1
I	Mastic	Brown, Column	1
J	Mastic	Tan, Light Brown, Column	1
K	Mastic	Dark Brown, Column	1
L	Mortar Bed	Gray	1
M	Basecove/Mastic	6" Brown/ Yellow/Beige	1
N	Mastic	White, Carpet Square	1
O	Acoustic Ceiling Panel	2'x4' White, Chicken Feet	2
P	Sealant	White, Interior Store Front	1
Q	Basecove/Mastic	4" Brown/Brown/ Beige	2
R	Mastic	Black, Sink	1
S	Acoustic Ceiling Tile/Mastic	12" White, Fissured/Brown	1
T	Acoustic Ceiling Tile/Mastic	12" White, Pinhole/Brown	1
U	Mastic	Yellow, 2'x2' Rubber Floor	1

**CALIFORNIA STATE UNIVERSITY MARITIME ACADEMY
STUDENT SERVICES BUILDING
ASBESTOS SAMPLING INVENTORY**

HOMOGENEOUS ID	MATERIAL	DESCRIPTION	# OF SAMPLES
V	Basecove/Mastic	4" Black/Beige	1
W	Acoustic Ceiling Panel	2'x4' Pinhole Gouge (patch)	1
X	Acoustic Ceiling Panel	2'x4' White, Solid	1
Y	Mortar/Grout	Brown/Gray, Store Front	1
Z	Mortar/Grout	White/Gray, Ceramic Wall	1
AA	Mastic	White, FRP	1
BB	Mortar/Grout	White/Gray/Gray Ceramic Wall	1
CC	Mortar/Grout	Brown/Gray/Gray, Ceramic Floor	1
DD	Wallboard/Joint Compound	White/White, No Texture	1
EE	Concrete	Gray, Foundation	2
FF	Paint/Stucco	White/Gray, Exterior	3
GG	Sealant	White, Vinyl Window Frame	1
HH	Sealant	Black, Aluminum Window Frame	1
II	Sealant	Gray, Door Frame	1
JJ	Sealant	Off-White, Exterior Wall Seams	2
KK	Paint/Putty	Brown/Gray, Metal Window	1
LL	Brick/Mortar	Red/Gray	1
MM	Wallboard/Joint Compound	White/White, No Texture	1
NN	Insulation	White, Pipe Hanger	1
OO	Mastic	Gray, Wall	2
PP	Vapor Barrier	Black, Exterior Walls	1

**CALIFORNIA STATE UNIVERSITY MARITIME ACADEMY
STUDENT SERVICES BUILDING
ASBESTOS SAMPLING INVENTORY**

HOMOGENEOUS ID	MATERIAL	DESCRIPTION	# OF SAMPLES
QQ	Lightweight Concrete	White, Roof	1
RR	Sealant	Tan, Metal, Window Frames	1
SS	Wallboard/Joint Compound	White/White "Patina" Ceiling	1
TT	Roof Field	White & Black. Built-Up	2
UU	Parapet/Base	Black, Built-Up	2
VV	Mastic	Black, Roof	2
WW	Sealant	White, Gray & Black, Seams	2
XX	Foam/Coating	Yellow, White, Duct	2
YY	Sealant	Brown, Upper Flashing	1
ZZ	Mastic	Black, Lower Flashing	1
A3	Shingle/Underlayment	Black/Black, Mansard Roof	1

Asbestos samples in **red** are positive. Other materials in black are negative. If the material that you may impact is not clearly sampled in the above table than reach out to EH&S at safety@csum.edu. before impacting any material.

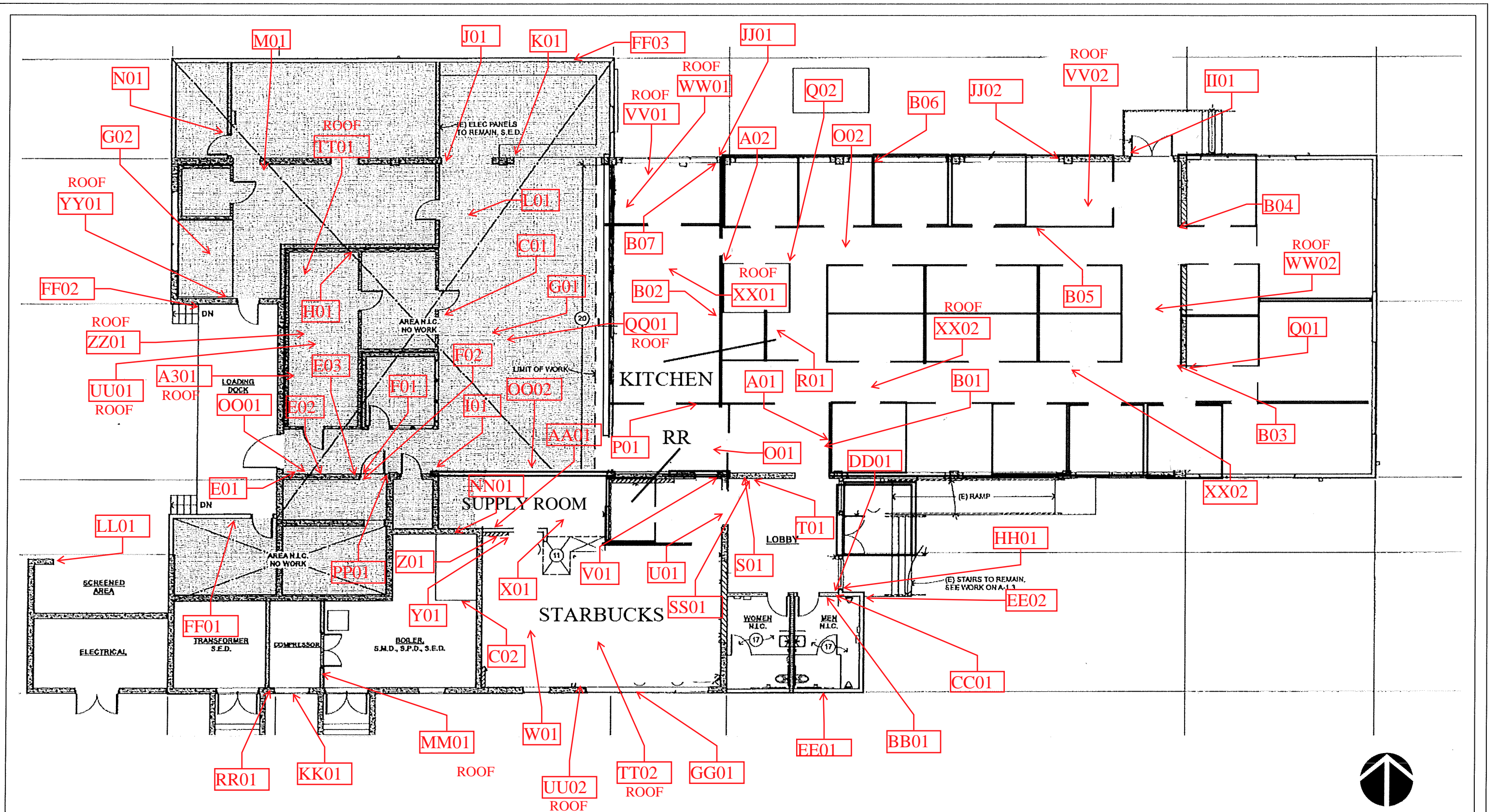

VISTA ENVIRONMENTAL CONSULTING
 www.vista-env.com
 2984 TEAGARDEN STREET
 SAN LEANDRO, CA 94577
 510-346-8860

PROJECT TITLE
**CAL MARITIME ACADEMY
 VALLEJO, CALIFORNIA**

SHEET TITLE
**STUDENT SERVICES
 SAMPLE LOCATION DRAWING**

SCALE:
 DRAWN BY:
 CHECKED BY:
 PROJECT No.
 DATE:
 DRAWING No.



FIGURE
1

CALIFORNIA STATE UNIVERSITY MARITIME ACADEMY
STUDENT SERVICES BUILDING
HAZARDOUS MATERIALS SUMMARY

Positive Lead XRF Locations

ROOM	COMPONENT	SUBSTRATE	COLOR	CONDITION	PB	UNITS
Inside	Wall	Concrete	White	Deteriorated	0.2	mg/cm ²
Inside	Door Frame	Metal	Red	Deteriorated	0.01	mg/cm ²
Inside	Beam	Metal	Beige	Deteriorated	6	mg/cm²
Inside	Door	Metal	Blue	Intact	0.01	mg/cm ²
Inside	Door Frame	Metal	Beige	Deteriorated	4.3	mg/cm²
Inside	Beam	Metal	Orange	Intact	3.3	mg/cm²
Inside	Window Sill	Wood	Beige	Intact	0.26	mg/cm ²
Inside	Wall	Porcelain	Gray	Intact	0.01	mg/cm ²
Inside	Wall Panel	Plastic	White	Deteriorated	2.5	mg/cm²
Inside	Pipe	Metal	White	Deteriorated	0.15	mg/cm ²
Outside	Downspout	Metal	Beige	Intact	0.02	mg/cm ²
Outside	Pipe	Metal	Blue	Deteriorated	0.01	mg/cm ²
Outside	Hand Rail	Metal	Black	Intact	0.08	mg/cm ²
Outside	Hand Rail	Metal	Brown	Deteriorated	0.4	mg/cm ²
Outside	Eave	Wood	Brown	Intact	0.5	mg/cm ²
Outside	Fascia	Wood	Brown	Intact	1	mg/cm²
Outside	Flashing	Metal	Brown	Intact	0.02	mg/cm ²
Inside	Ladder	Metal	Black	Intact	0.07	mg/cm ²
Roof	HVAC	Metal	Brown	Deteriorated	0.01	mg/cm ²
Roof	Pipe	Metal	Brown	Intact	0.08	mg/cm ²

Bold = Lead Based

CSUMA
Student Services Building
XRF Sample Locations

READING NO.	BUILDING	ROOM	COMPONENT	SUBSTRATE	COLOR	CONDITION	RESULTS	PbC	UNITS
1			SHUTTER_CAL					0.63	cps
4			CALIBRATE				Negative	0.9	mg/cm ²
7	Student Services	INSIDE	WALL	CONCRETE	WHITE	DETERIORATED	Negative	0.2	mg/cm ²
8	Student Services	INSIDE	DOOR FRAME	METAL	RED	DETERIORATED	Negative	0.01	mg/cm ²
9	Student Services	INSIDE	BEAM	METAL	BEIGE	DETERIORATED	Positive	6	mg/cm ²
10	Student Services	INSIDE	PIPE	METAL	BLACK	DETERIORATED	Negative	0	mg/cm ²
11	Student Services	INSIDE	WALL PANEL	WOOD	WHITE	INTACT	Negative	0	mg/cm ²
12	Student Services	INSIDE	DOOR	METAL	BLUE	INTACT	Negative	0.01	mg/cm ²
13	Student Services	INSIDE	DOOR FRAME	METAL	BEIGE	DETERIORATED	Positive	4.3	mg/cm ²
14	Student Services	INSIDE	DOOR FRAME	WOOD	BEIGE	INTACT	Negative	0	mg/cm ²
15	Student Services	INSIDE	BEAM	METAL	ORANGE	INTACT	Positive	3.3	mg/cm ²
16	Student Services	INSIDE	WALL	DRYWALL	WHITE	INTACT	Negative	0	mg/cm ²
17	Student Services	INSIDE	WALL	DRYWALL	YELLOW	INTACT	Negative	0	mg/cm ²
18	Student Services	INSIDE	WALL	DRYWALL	BEIGE	INTACT	Negative	0	mg/cm ²
19	Student Services	INSIDE	WALL	CONCRETE	BEIGE	INTACT	Negative	0	mg/cm ²
20	Student Services	INSIDE	WINDOW SILL	WOOD	YELLOW	INTACT	Negative	0	mg/cm ²
21	Student Services	INSIDE	WINDOW SILL	WOOD	BEIGE	INTACT	Negative	0.26	mg/cm ²
22	Student Services	INSIDE	WALL	PORCELAIN	GRAY	INTACT	Negative	0.01	mg/cm ²
23	Student Services	INSIDE	DOOR FRAME	METAL	BLACK	INTACT	Negative	0	mg/cm ²
24	Student Services	INSIDE	DOOR	METAL	BLACK	INTACT	Negative	0	mg/cm ²
25	Student Services	INSIDE	DOOR	METAL	BLACK	INTACT	Negative	0	mg/cm ²
26	Student Services	INSIDE	WALL	DRYWALL	BLUE	DETERIORATED	Negative	0	mg/cm ²
27	Student Services	INSIDE	DOOR	WOOD	WHITE	DETERIORATED	Negative	0	mg/cm ²
28	Student Services	INSIDE	WALL PANEL	PLASTIC	WHITE	DETERIORATED	Positive	2.5	mg/cm ²
29	Student Services	INSIDE	FLOOR	PORCELAIN	BROWN	INTACT	Negative	0	mg/cm ²

This data is a screening of lead levels and provides results that are generally representative of typical conditions, but are not inclusive of all painted/coated surfaces at the Project Site.

**CSUMA
Student Services Building
XRF Sample Locations**

READING NO.	BUILDING	ROOM	COMPONENT	SUBSTRATE	COLOR	CONDITION	RESULTS	PbC	UNITS
30	Student Services	INSIDE	WALL	PORCELAIN	BEIGE	INTACT	Negative	0	mg/cm ²
31	Student Services	INSIDE	PIPE	METAL	WHITE	DETERIORATED	Negative	0.15	mg/cm ²
32	Student Services	OUTSIDE	WALL	STUCCO	BEIGE	DETERIORATED	Negative	0	mg/cm ²
33	Student Services	OUTSIDE	DOOR	METAL	BROWN	INTACT	Negative	0	mg/cm ²
34	Student Services	OUTSIDE	DOWNSPOUT	METAL	BEIGE	INTACT	Negative	0.02	mg/cm ²
35	Student Services	OUTSIDE	FOUNDATION	CONCRETE	BEIGE	INTACT	Negative	0	mg/cm ²
36	Student Services	OUTSIDE	PIPE	METAL	BLUE	DETERIORATED	Negative	0.01	mg/cm ²
37	Student Services	OUTSIDE	PIPE	METAL	YELLOW	INTACT	Negative	0	mg/cm ²
38	Student Services	OUTSIDE	HAND RAIL	METAL	BLACK	INTACT	Negative	0.08	mg/cm ²
39	Student Services	OUTSIDE	STAIRS	CONCRETE	BLACK	INTACT	Negative	0	mg/cm ²
40	Student Services	OUTSIDE	DOOR	PLASTIC	BLACK	INTACT	Negative	0	mg/cm ²
41	Student Services	OUTSIDE	WALL	STUCCO	BROWN	INTACT	Negative	0	mg/cm ²
42	Student Services	OUTSIDE	WINDOW FRAME	METAL	BROWN	INTACT	Negative	0	mg/cm ²
43	Student Services	OUTSIDE	HAND RAIL	METAL	BROWN	DETERIORATED	Negative	0.4	mg/cm ²
44	Student Services	OUTSIDE	EAVE	WOOD	BROWN	INTACT	Negative	0.5	mg/cm ²
45	Student Services	OUTSIDE	FASCIA	WOOD	BROWN	INTACT	Positive	1	mg/cm ²
46	Student Services	OUTSIDE	FLASHING	METAL	BROWN	INTACT	Negative	0.02	mg/cm ²
47	Student Services	INSIDE	LADDER	METAL	BLACK	INTACT	Negative	0.07	mg/cm ²
48	Student Services	ROOF	HVAC	METAL	BEIGE	INTACT	Negative	0	mg/cm ²
49	Student Services	ROOF	HVAC	METAL	BROWN	DETERIORATED	Negative	0.01	mg/cm ²
50	Student Services	ROOF	PIPE COVERING	METAL	WHITE	INTACT	Negative	0	mg/cm ²
51	Student Services	ROOF	PIPE	METAL	BROWN	INTACT	Negative	0.08	mg/cm ²
52	Student Services	ROOF	PIPE	METAL	BLACK	INTACT	Negative	0	mg/cm ²
85			CALIBRATE				Positive	1	mg/cm ²
86			CALIBRATE				Negative	0.8	mg/cm ²

This data is a screening of lead levels and provides results that are generally representative of typical conditions, but are not inclusive of all painted/coated surfaces at the Project Site.

**CSUMA
Student Services Building
XRF Sample Locations**

READING NO.	BUILDING	ROOM	COMPONENT	SUBSTRATE	COLOR	CONDITION	RESULTS	PbC	UNITS
87			CALIBRATE				Positive	1	mg/cm ²

The above list are ALL the materials sampled and tested by XRF for lead. The positive materials are in red. The non-detect samples for lead materials are in black. If you cannot positively identify the material you need to impact through the above inventory, do not disturb and contact EH&S for further sampling or guidance. The materials not listed were not sampled and must be assumed lead containing until proven not by testing.