

CALIFORNIA STATE UNIVERSITY MARITIME ACADEMY - TECHNOLOGY BUILDING
HAZARDOUS MATERIALS SURVEY



Sampled for **asbestos** and **detected**
Sampled for **lead** and **detected**

This is a quick reference summary of a survey completed by Vista Environmental in October 2024. The complete report is available by contacting EH&S at safety@csum.edu. If unsure about ANY information contact EH&S prior to impacting suspect material.

Positive Asbestos Locations

MATERIAL	DESCRIPTION	LOCATION	ESTIMATED QUANTITY
Paint/Concrete Masonry Unit/Grout	Olive/Gray/Gray	North Central Wing - South and West Hallway, Makers Room, and Adjacent Classroom. Asbestos is in Paint layer	2,800 SF
Lab Table	Black	Shop Area and Tool Room	240 SF
Sealant	White, Upper Roof Parapet	Upper Roof Parapet. Asbestos is in Silver Paint Layer	25 SF (300 LF)

The results of the bulk samples collected for asbestos, and analyzed by PLM, or assumed, indicate that detectable concentrations of asbestos *are present* in the following materials:

HOMO ID	MATERIAL	DESCRIPTION	LOCATION	CAL/OSHA CLASS	BAAQMD CATEGORY
R	Paint/Concrete Masonry Unit/Grout	Olive/Gray/Gray	North Central Wing - South and West Hallway, Makers Room, and Adjacent Classroom. Asbestos is in Paint layer	Class II	Category II - Non-Friable
MM	Lab Table	Black	Shop Area and Tool Room	Class II	Category II - Non-Friable
SS	Sealant	White, Upper Roof Parapet	Upper Roof Parapet. Asbestos is in Silver Paint Layer	Class II	Category II - Non-Friable

The results of the bulk samples collected for asbestos, and analyzed by PLM, indicate that detectable concentrations of asbestos ***are not present*** in the following materials:

HOMOGENEOUS ID	MATERIAL	DESCRIPTION	# OF SAMPLES
A	Paint/Stucco	White/Gray, Eave, Upper Wall	3
B	Brick/Mortar	Red/Gray, Lower Wall	2
C	Concrete	Gray, Foundation	2
D	Sealant	Gray, Window Frame, Store Front, Louver	2
E	Shingle/Underlayment	Black/Black, Hatch	1
F	Sealant	White, Glass Cube Window Seams	2
H	Wallboard/Joint Compound	White/White	3
I	Texture Coat	White, Small	7
J	Basecove/Mastic	4" Black/Brown	2
K	Vinyl Sheet Flooring/Mastic	Blue Marbled/Yellow	2
L	Acoustical Ceiling Panel	Multiple Sizes, White, Textured	2
M	Mastic	Clear Carpet	2
N	Coating	Olive, Floor	2
O	Acoustical Ceiling Tile/Mastic	12" White, Fissured, Pinhole/Yellow	2
P	Vinyl Sheet Flooring/Mastic	Gray Marbled/Tan	2
Q	Mastic	Yellow, Wainscot	1
S	Acoustical Ceiling Panel	2'x4' White, Chicken Feet	2

The results of the bulk samples collected for asbestos, and analyzed by PLM, indicate that detectable concentrations of asbestos ***are not present*** in the following materials:

HOMOGENEOUS ID	MATERIAL	DESCRIPTION	# OF SAMPLES
T	Acoustical Ceiling Panel	2'x4' White, Gouge	2
U	Mastic	Black, Sink, Undercoating	1
V	Sealant	White, Door Frame	2
W	Jacketing	White, Fiberglass Pipe	2
X	Tape	White, HVAC	2
Y	Firestop	Red	2
Z	Basecove/Mastic	4" Brown/Brown	2
AA	Sealant	Tan, Duct Inner Seam	2
BB	Vinyl Floor Tile/Mastic	12" White/Brown	2
CC	Vinyl Floor Tile/Mastic	2'x4' Gray, Non-Stick/Yellow	1
DD	Insulation	Beige, Pipe Hanger	2
EE	Acoustical Ceiling Panel	2'x4' White, Fissured	2
FF	Mastic	Brown, Wall	1
GG	Vinyl Floor Tile/Mastic	Brown & Gray, Floor/ Yellow	2
HH	Vinyl Floor Tile/Mastic	12" White/Black Streaks	1
II	Flex Connector	White, HVAC	1
JJ	Vinyl Sheet Flooring	White, Marbled	2
KK	Basecove/Mastic	6" Black/Brown	1
LL	Sealant	Gray, Door Frame	1
NN	Sealant	Gray, HVAC, Exterior	2
OO	Wrap	Black, Pipe	1
PP	Roofing	Gray & Black, Built-Up	2
QQ	Parapet	Gray & Black, Built-Up	2
RR	Mastic	Gray & Black	2
TT	Sealant	Gray, Round Duct	1
UU	Sealant	White, Patch	1
VV	Roofing	Silver & Black, Upper	1
WW	Parapet	Silver & Black, Upper	1
XX	Sealant	Tan, Flashing Seam	1
YY	Sealant	White, Flashing on Brick	1

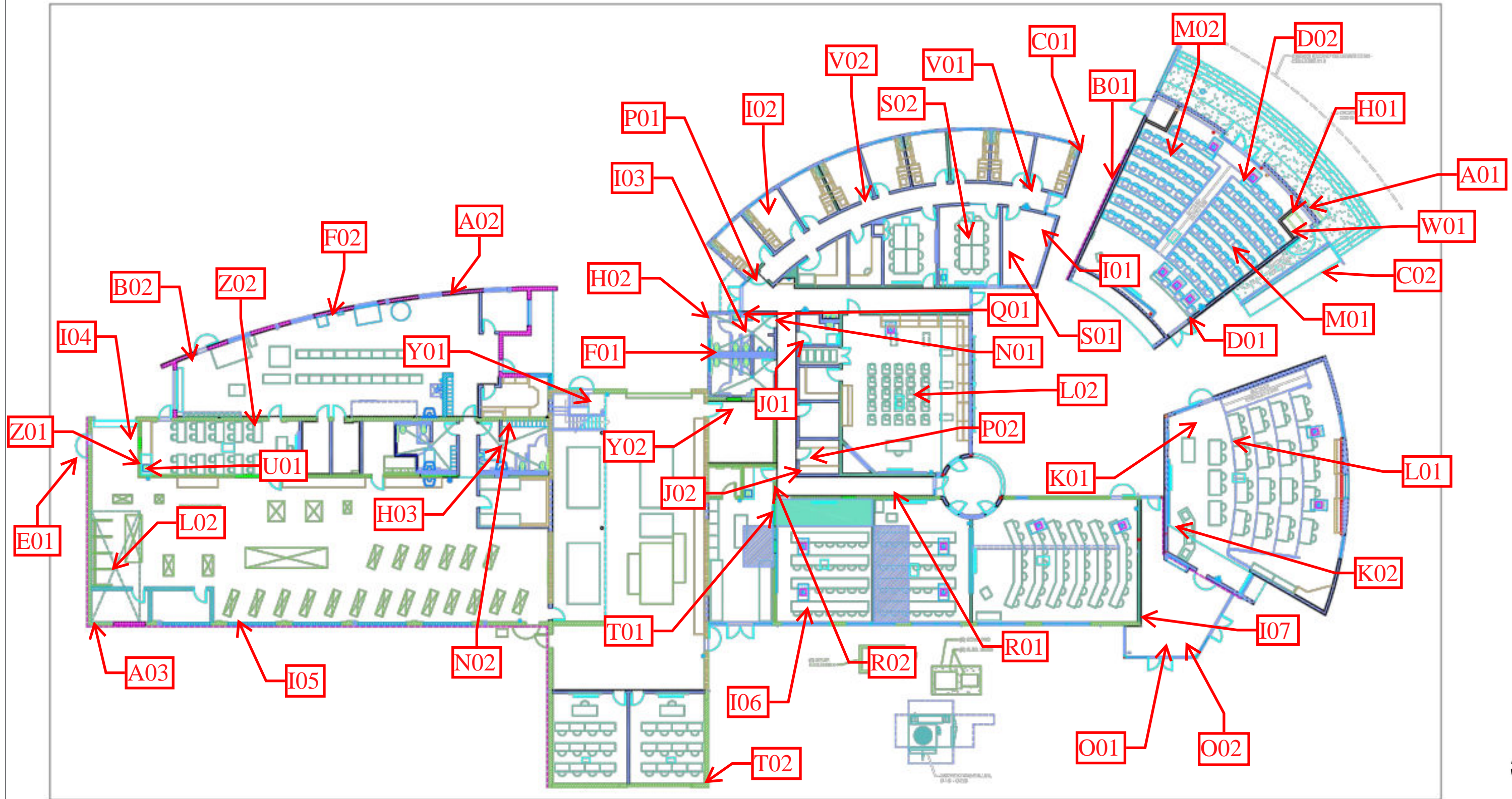

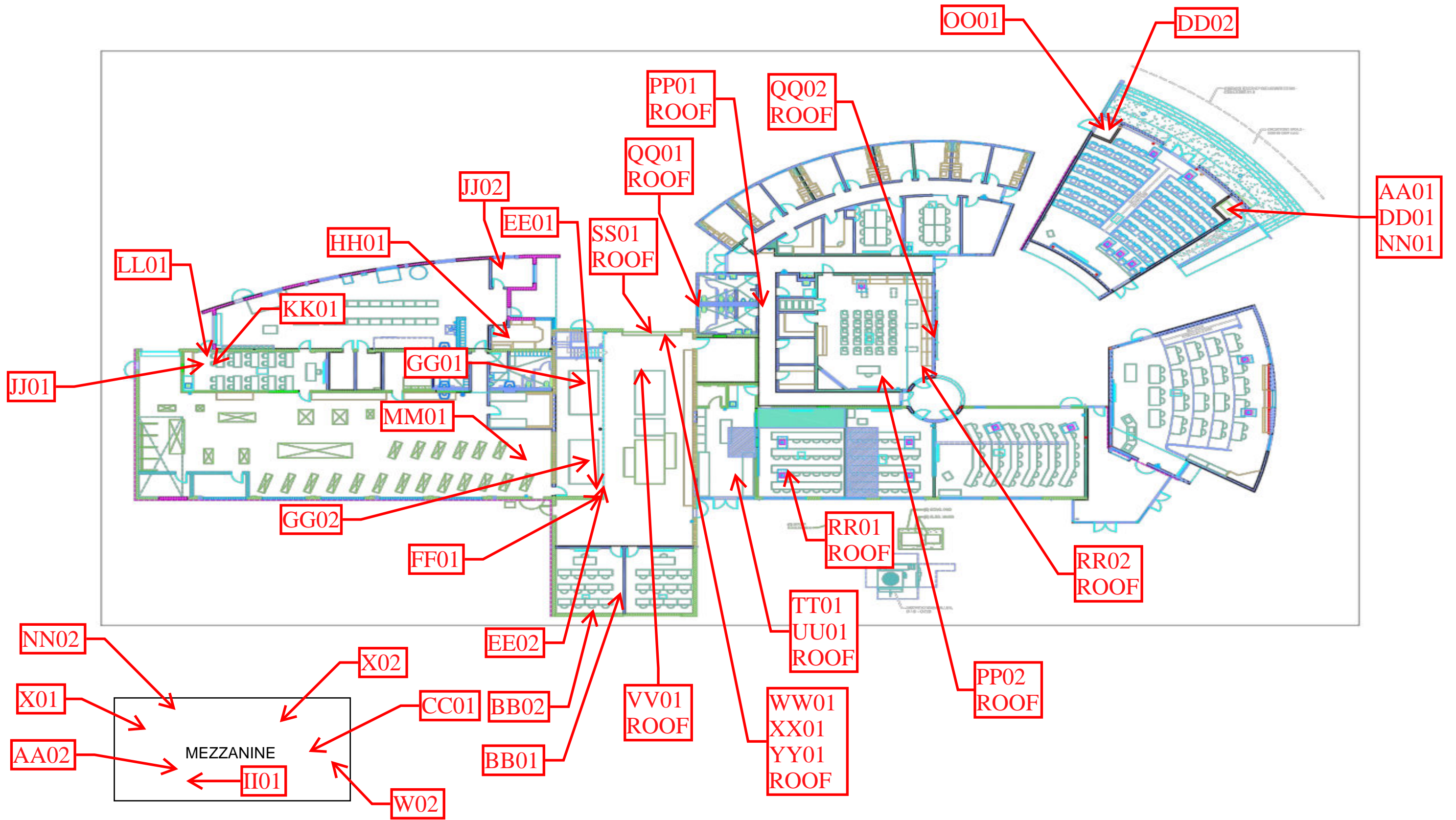

Positive Lead XRF Locations

ROOM	COMPONENT	SUBSTRATE	COLOR	CONDITION	Pb	UNITS
Outside	Lower Wall	Stucco	White	Intact	0.1	mg/cm ²
Outside	Door	Metal	Light Gray	Intact	0.1	mg/cm ²
Outside	Door Frame	Metal	Light Gray	Intact	0.2	mg/cm ²
Outside	Post	Metal	White	Intact	0.1	mg/cm ²
Outside	Post	Metal	White	Intact	0.2	mg/cm ²
Outside	Beam	Metal	White	Intact	0.1	mg/cm ²
Inside	Lower Wall	Drywall	Beige	Intact	0.1	mg/cm ²
Inside	Lower Wall	Drywall	Beige	Intact	0.1	mg/cm ²
Inside	Door	Wood	Varnish	Intact	0.1	mg/cm ²
Inside	Door	Wood	Varnish	Intact	0.1	mg/cm ²
Inside	Door Frame	Metal	Off White	Intact	0.1	mg/cm ²
Inside	Baseboard	Vinyl	Black	Intact	0.3	mg/cm ²
Inside	Baseboard	Vinyl	Black	Intact	0.2	mg/cm ²
Inside	Lower Wall	Vinyl	Off White	Intact	0.2	mg/cm ²
Inside	Lower Wall	Vinyl	Off White	Intact	0.2	mg/cm ²
Inside	Floor	Other	Gray	Intact	0.2	mg/cm ²
Inside	Lower Wall	Other	Beige	Intact	0.1	mg/cm ²
Inside	Lower Wall	Stucco	Blue	Intact	0.1	mg/cm ²
Inside	Lower Wall	Stucco	Blue	Intact	0.2	mg/cm ²
Inside	Floor	Other	Green	Intact	0.2	mg/cm ²
Outside	Lower Wall	Drywall	Tan	Intact	0.1	mg/cm ²
Outside	Lower Wall	Drywall	White	Intact	0.1	mg/cm ²
Outside	Lower Wall	Drywall	White	Intact	0.1	mg/cm ²
Inside	Post	Metal	White	Intact	0.1	mg/cm ²
Inside	Post	Metal	White	Intact	0.1	mg/cm ²
Inside	Beam	Metal	White	Intact	0.1	mg/cm ²
Inside	Beam	Metal	White	Intact	0.2	mg/cm ²
Outside	Lower Wall	Wood	White	Intact	0.1	mg/cm ²
Outside	Downspout	Metal	Other	Intact	0.1	mg/cm ²
Outside	Door	Metal	Beige	Intact	0.1	mg/cm ²
Outside	Door Frame	Metal	Beige	Intact	0.1	mg/cm ²
Outside	Door Frame	Metal	Beige	Intact	0.1	mg/cm ²
Outside	Garage Door	Metal	White	Intact	0.1	mg/cm ²
Outside	Garage Door	Metal	White	Intact	0.1	mg/cm ²
Outside	Garage Door Frame	Metal	Beige	Intact	0.1	mg/cm ²
Outside	Garage Door Frame	Metal	Beige	Intact	0.1	mg/cm ²
Outside	Upper Wall	Brick	Off White	Intact	0.2	mg/cm ²

Positive Lead XRF Locations

ROOM	COMPONENT	SUBSTRATE	COLOR	CONDITION	Pb	UNITS
Outside	Upper Wall	Brick	Off White	Intact	0.1	mg/cm ²
Inside	Lower Wall	Drywall	Blue	Intact	0.1	mg/cm ²
Inside	Lower Wall	Drywall	Blue	Intact	0.1	mg/cm ²
Inside	Upper Wall	Drywall	White	Intact	0.1	mg/cm ²
Inside	Floor	Other	Gray	Intact	0.3	mg/cm ²
Inside	Floor	Other	Gray	Intact	0.2	mg/cm ²
Inside	Post	Metal	White	Intact	0.1	mg/cm ²
Inside	Post	Metal	White	Intact	0.2	mg/cm ²
Inside	Lower Wall	Other	White	Intact	0.1	mg/cm ²
Inside	Lower Wall	Other	Blue	Intact	0.1	mg/cm ²
Inside	Lower Wall	Plaster	White	Intact	0.1	mg/cm ²
Inside	Lower Wall	Plaster	White	Intact	0.1	mg/cm ²
Inside	Stringer	Metal	Off White	Intact	0.1	mg/cm ²
Inside	Riser	Metal	Off White	Intact	0.1	mg/cm ²
Inside	Railing	Metal	Off White	Intact	0.1	mg/cm ²
Inside	Door	Wood	Blue	Intact	0.1	mg/cm ²
Inside	Door Frame	Metal	Blue	Intact	0.1	mg/cm ²
Inside	Baseboard	Vinyl	Black	Intact	0.1	mg/cm ²
Inside	Baseboard	Vinyl	Black	Intact	0.2	mg/cm ²
Inside	Beam	Metal	Off White	Intact	0.1	mg/cm ²
Inside	Beam	Metal	Off White	Intact	0.1	mg/cm ²
Inside	Lower Wall	Drywall	Light Gray	Intact	0.2	mg/cm ²
Inside	Lower Wall	Brick	Off White	Intact	0.2	mg/cm ²
Inside	Beam	Metal	Tan	Intact	8.5	mg/cm²
Inside	Beam	Metal	Tan	Intact	5.3	mg/cm²
Inside	Beam	Wood	Tan	Intact	0.2	mg/cm ²
Inside	Beam	Wood	Tan	Intact	0.2	mg/cm ²
Inside	Ceiling	Wood	Tan	Intact	0.1	mg/cm ²
Inside	Ceiling	Wood	Tan	Intact	0.1	mg/cm ²
Inside	Stringer	Metal	Light Gray	Intact	0.1	mg/cm ²
Inside	Railing	Metal	Light Gray	Intact	0.1	mg/cm ²
Inside	Baseboard	Vinyl	Dark Brown	Intact	0.2	mg/cm ²
Inside	Baseboard	Vinyl	Dark Brown	Intact	0.2	mg/cm ²
Outside	Pipe	Metal	Silver	Intact	72	mg/cm²
Outside	HVAC	Metal	Light Gray	Intact	0.1	mg/cm ²
Outside	Downspout	Metal	Dark Brown	Intact	0.1	mg/cm ²
Outside	Gutter	Metal	Dark Brown	Intact	0.1	mg/cm ²
Outside	Gutter	Metal	Dark Brown	Intact	0.1	mg/cm ²
Outside	Roofing	Other	Silver	Intact	0.1	mg/cm ²
Outside	Roofing	Other	Silver	Intact	0.2	mg/cm ²

Bold = Lead Based

XFR Lead Sample Locations

READING NO.	ROOM	COMPONENT	SUBSTRATE	COLOR	CONDITION	RESULTS	PbC	UNITS
96		Calibrate				Negative	0.8	mg/cm2
97		Calibrate				Negative	0.8	mg/cm2
98		Calibrate				Negative	0.8	mg/cm2
299	Outside	Lower Wall	Stucco	White	Intact	Negative	0.1	mg/cm2
300	Outside	Lower Wall	Stucco	White	Intact	Negative	0	mg/cm2
301	Outside	Door	Metal	Lt-Gray	Intact	Negative	0.1	mg/cm2
302	Outside	Door	Metal	Lt-Gray	Intact	Negative	0	mg/cm2
303	Outside	Door Frame	Metal	Lt-Gray	Intact	Negative	0	mg/cm2
304	Outside	Door Frame	Metal	Lt-Gray	Intact	Negative	0.2	mg/cm2
305	Outside	Post	Metal	White	Intact	Negative	0.1	mg/cm2
306	Outside	Post	Metal	White	Intact	Negative	0.2	mg/cm2
307	Outside	Beam	Metal	White	Intact	Negative	0	mg/cm2
308	Outside	Beam	Metal	White	Intact	Negative	0.1	mg/cm2
309	Inside	Lower Wall	Drywall	Beige	Intact	Negative	0.1	mg/cm2
310	Inside	Lower Wall	Drywall	Beige	Intact	Negative	0.1	mg/cm2
311	Inside	Door	Wood	Varnish	Intact	Negative	0.1	mg/cm2
312	Inside	Door	Wood	Varnish	Intact	Negative	0.1	mg/cm2
313	Inside	Door Frame	Metal	Off White	Intact	Negative	0.1	mg/cm2
314	Inside	Door Frame	Metal	Off White	Intact	Negative	0	mg/cm2
315	Inside	Baseboard	Vinyl	Black	Intact	Negative	0.3	mg/cm2
316	Inside	Baseboard	Vinyl	Black	Intact	Negative	0.2	mg/cm2
317	Inside	Lower Wall	Vinyl	Off White	Intact	Negative	0.2	mg/cm2
318	Inside	Lower Wall	Vinyl	Off White	Intact	Negative	0.2	mg/cm2
319	Inside	Floor	Other	Gray	Intact	Negative	0	mg/cm2
320	Inside	Floor	Other	Gray	Intact	Negative	0.2	mg/cm2
321	Inside	Lower Wall	Other	Beige	Intact	Negative	0	mg/cm2
322	Inside	Lower Wall	Other	Beige	Intact	Negative	0.1	mg/cm2
323	Inside	Lower Wall	Brick	Beige	Intact	Negative	0	mg/cm2

This data is a screening of lead levels and provides results that are generally representative of typical conditions, but are not inclusive of all painted/coated surfaces at the Project Site.

READING NO.	ROOM	COMPONENT	SUBSTRATE	COLOR	CONDITION	RESULTS	PbC	UNITS
324	Inside	Lower Wall	Stucco	Blue	Intact	Negative	0.1	mg/cm ²
325	Inside	Lower Wall	Stucco	Blue	Intact	Negative	0.2	mg/cm ²
326	Inside	Floor	Other	Green	Intact	Negative	0	mg/cm ²
327	Inside	Floor	Other	Green	Intact	Negative	0.2	mg/cm ²
328		Calibrate				Negative	0.9	mg/cm ²
329		Calibrate				Negative	0.9	mg/cm ²
330		Calibrate				Positive	1	mg/cm ²
331		Calibrate				Positive	1	mg/cm ²
332		Calibrate				Negative	0.9	mg/cm ²
333		Calibrate				Positive	1	mg/cm ²
334	Outside	Lower Wall	Drywall	Tan	Intact	Negative	0	mg/cm ²
335	Outside	Lower Wall	Drywall	Tan	Intact	Negative	0.1	mg/cm ²
336	Outside	Lower Wall	Drywall	White	Intact	Negative	0.1	mg/cm ²
337	Outside	Lower Wall	Drywall	White	Intact	Negative	0.1	mg/cm ²
338	Inside	Post	Metal	White	Intact	Negative	0.1	mg/cm ²
339	Inside	Post	Metal	White	Intact	Negative	0.1	mg/cm ²
340	Inside	Beam	Metal	White	Intact	Negative	0.1	mg/cm ²
341	Inside	Beam	Metal	White	Intact	Negative	0.2	mg/cm ²
342	Outside	Upper Wall	Stucco	White	Intact	Negative	0	mg/cm ²
343	Outside	Upper Wall	Stucco	White	Intact	Negative	0	mg/cm ²
344	Outside	Lower Wall	Wood	White	Intact	Negative	0.1	mg/cm ²
345	Outside	Lower Wall	Wood	White	Intact	Negative	0	mg/cm ²
346	Outside	Downspout	Metal	Other	Intact	Negative	0.1	mg/cm ²
347	Outside	Downspout	Metal	Other	Intact	Negative	0	mg/cm ²
348	Outside	Door	Metal	Beige	Intact	Negative	0.1	mg/cm ²
349	Outside	Door	Metal	Beige	Intact	Negative	0	mg/cm ²
350	Outside	Door Frame	Metal	Beige	Intact	Negative	0.1	mg/cm ²
351	Outside	Door Frame	Metal	Beige	Intact	Negative	0.1	mg/cm ²

This data is a screening of lead levels and provides results that are generally representative of typical conditions, but are not inclusive of all painted/coated surfaces at the Project Site.

READING NO.	ROOM	COMPONENT	SUBSTRATE	COLOR	CONDITION	RESULTS	PbC	UNITS
352	Outside	Garage Door	Metal	White	Intact	Negative	0.1	mg/cm ²
353	Outside	Garage Door	Metal	White	Intact	Negative	0.1	mg/cm ²
354	Outside	Garage Door Frame	Metal	Beige	Intact	Negative	0.1	mg/cm ²
355	Outside	Garage Door Frame	Metal	Beige	Intact	Negative	0.1	mg/cm ²
356	Outside	Upper Wall	Brick	Off White	Intact	Negative	0.2	mg/cm ²
357	Outside	Upper Wall	Brick	Off White	Intact	Negative	0.1	mg/cm ²
358	Inside	Lower Wall	Drywall	Blue	Intact	Negative	0.1	mg/cm ²
359	Inside	Lower Wall	Drywall	Blue	Intact	Negative	0.1	mg/cm ²
360	Inside	Upper Wall	Drywall	White	Intact	Negative	0.1	mg/cm ²
361	Inside	Upper Wall	Drywall	White	Intact	Negative	0	mg/cm ²
362	Inside	Floor	Other	Gray	Intact	Negative	0.3	mg/cm ²
363	Inside	Floor	Other	Gray	Intact	Negative	0.2	mg/cm ²
364	Inside	Post	Metal	White	Intact	Negative	0.1	mg/cm ²
365	Inside	Post	Metal	White	Intact	Negative	0.2	mg/cm ²
366	Inside	Lower Wall	Other	White	Intact	Negative	0.1	mg/cm ²
367	Inside	Lower Wall	Other	White	Intact	Negative	0	mg/cm ²
368	Inside	Lower Wall	Other	Blue	Intact	Negative	0.1	mg/cm ²
369	Inside	Lower Wall	Other	Blue	Intact	Negative	0	mg/cm ²
370	Inside	Lower Wall	Plaster	White	Intact	Negative	0.1	mg/cm ²
371	Inside	Lower Wall	Plaster	White	Intact	Negative	0.1	mg/cm ²
372	Inside	Door	Wood	Varnish	Intact	Negative	0	mg/cm ²
373	Inside	Door	Wood	Varnish	Intact	Negative	0	mg/cm ²
374	Inside	Door Frame	Metal	Blue	Intact	Negative	0	mg/cm ²
375	Inside	Door Frame	Metal	Blue	Intact	Negative	0	mg/cm ²
376	Inside	Stringer	Metal	Off White	Intact	Negative	0	mg/cm ²
377	Inside	Stringer	Metal	Off White	Intact	Negative	0.1	mg/cm ²
378	Inside	Riser	Metal	Off White	Intact	Negative	0.1	mg/cm ²
379	Inside	Riser	Metal	Off White	Intact	Negative	0	mg/cm ²

This data is a screening of lead levels and provides results that are generally representative of typical conditions, but are not inclusive of all painted/coated surfaces at the Project Site.

READING NO.	ROOM	COMPONENT	SUBSTRATE	COLOR	CONDITION	RESULTS	PbC	UNITS
380	Inside	Railing	Metal	Off White	Intact	Negative	0	mg/cm2
381	Inside	Railing	Metal	Off White	Intact	Negative	0.1	mg/cm2
382	Inside	Door	Wood	Blue	Intact	Negative	0	mg/cm2
383	Inside	Door	Wood	Blue	Intact	Negative	0.1	mg/cm2
384	Inside	Door Frame	Metal	Blue	Intact	Negative	0.1	mg/cm2
385	Inside	Door Frame	Metal	Blue	Intact	Negative	0	mg/cm2
386	Inside	Floor	Other	Lt-Gray	Intact	Negative	0	mg/cm2
387	Inside	Floor	Other	Lt-Gray	Intact	Negative	0	mg/cm2
388	Inside	Baseboard	Vinyl	Black	Intact	Negative	0.1	mg/cm2
389	Inside	Baseboard	Vinyl	Black	Intact	Negative	0.2	mg/cm2
390	Inside	Beam	Metal	Off White	Intact	Negative	0.1	mg/cm2
391	Inside	Beam	Metal	Off White	Intact	Negative	0.1	mg/cm2
392	Inside	Lower Wall	Drywall	Lt-Gray	Intact	Negative	0.2	mg/cm2
393	Inside	Lower Wall	Drywall	Lt-Gray	Intact	Negative	0	mg/cm2
394	Inside	Lower Wall	Brick	Lt-Gray	Intact	Negative	0	mg/cm2
395	Inside	Lower Wall	Brick	Lt-Gray	Intact	Negative	0	mg/cm2
396	Inside	Lower Wall	Brick	Off White	Intact	Negative	0.2	mg/cm2
397	Inside	Lower Wall	Brick	Off White	Intact	Negative	0	mg/cm2
398	Inside	Beam	Metal	Tan	Intact	Positive	8.5	mg/cm2
399	Inside	Beam	Metal	Tan	Intact	Positive	5.3	mg/cm2
400	Inside	Beam	Wood	Tan	Intact	Negative	0.2	mg/cm2
401	Inside	Beam	Wood	Tan	Intact	Negative	0.2	mg/cm2
402	Inside	Ceiling	Wood	Tan	Intact	Negative	0.1	mg/cm2
403	Inside	Ceiling	Wood	Tan	Intact	Negative	0.1	mg/cm2
404	Inside	Railing	Metal	White	Intact	Negative	0	mg/cm2
405	Inside	Railing	Metal	White	Intact	Negative	0	mg/cm2
406	Inside	Stairs	Metal	Lt-Gray	Intact	Negative	0	mg/cm2
407	Inside	Stairs	Metal	Lt-Gray	Intact	Negative	0	mg/cm2

This data is a screening of lead levels and provides results that are generally representative of typical conditions, but are not inclusive of all painted/coated surfaces at the Project Site.

READING NO.	ROOM	COMPONENT	SUBSTRATE	COLOR	CONDITION	RESULTS	PbC	UNITS
408	Inside	Stringer	Metal	Lt-Gray	Intact	Negative	0	mg/cm2
409	Inside	Stringer	Metal	Lt-Gray	Intact	Negative	0.1	mg/cm2
410	Inside	Railing	Metal	Lt-Gray	Intact	Negative	0.1	mg/cm2
411	Inside	Railing	Metal	Lt-Gray	Intact	Negative	0	mg/cm2
412	Inside	Baseboard	Vinyl	Dk-Brown	Intact	Negative	0.2	mg/cm2
413	Inside	Baseboard	Vinyl	Dk-Brown	Intact	Negative	0.2	mg/cm2
414	Outside	Pipe	Metal	Silver	Intact	Positive	72	mg/cm2
415	Outside	HVAC	Metal	Lt-Gray	Intact	Negative	0.1	mg/cm2
416	Outside	HVAC	Metal	Lt-Gray	Intact	Negative	0	mg/cm2
417	Outside	Downspout	Metal	Dk-Brown	Intact	Negative	0.1	mg/cm2
418	Outside	Downspout	Metal	Dk-Brown	Intact	Negative	0	mg/cm2
419	Outside	Gutter	Metal	Dk-Brown	Intact	Negative	0.1	mg/cm2
420	Outside	Gutter	Metal	Dk-Brown	Intact	Negative	0.1	mg/cm2
421	Outside	Roofing	Other	Silver	Intact	Negative	0.1	mg/cm2
422	Outside	Roofing	Other	Silver	Intact	Negative	0.2	mg/cm2
423		Calibrate				Positive	1	mg/cm2
424		Calibrate				Positive	1.1	mg/cm2
425		Calibrate				Positive	1.1	mg/cm2

The above list are ALL the materials sampled and tested by XRF for lead. The positive materials are in red. The non-detected for lead materials are in black. If you cannot positively identify the material you need to impact through the above inventory, do not disturb and contact EH&S for further sampling or guidance. The materials not listed were not sampled and must be assumed lead containing until proven not by testing.

This data is a screening of lead levels and provides results that are generally representative of typical conditions, but are not inclusive of all painted/coated surfaces at the Project Site.